



921038-00

230TP/TP-BE

VON DUPRIN®

TRIM

Installation Instructions

INSTALLATION INSTRUCTIONS

1. Prepare door for exit device. See exit device instructions for holes and center lines.
2. Prepare door for trim:
 - A. Transfer vertical center line from inside (exit device side) of door to outside (trim side) of door. Use extra care if edge of door is beveled. Be sure center line is parallel to edge of door.
 - B. Locate and prepare holes as shown.
3. For TP trim only, install mortise cylinder.
4. If necessary, convert trim for 2-1/4" thick door (see conversion instructions below).
5. Apply trim.
6. Apply exit device, thru-bolt to trim, and use screw with #12 countersink washer for lower trim mounting stud.

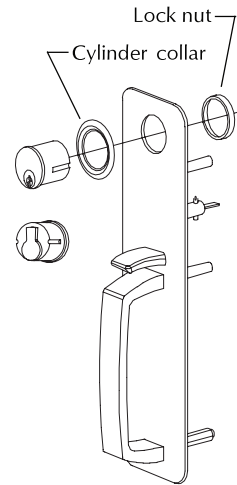

Use mortise cylinder with standard straight cam in position shown with key removed

CONVERSION FOR 2-1/4" THICK DOOR

Trim is shipped for 1-3/4" thick door. For 2-1/4" thick door:

1. Remove roll pin.
2. Pull shaft out to second hole.
3. Install roll pin thru TP cam into shaft and thru other side so it protrudes the same amount on each side.

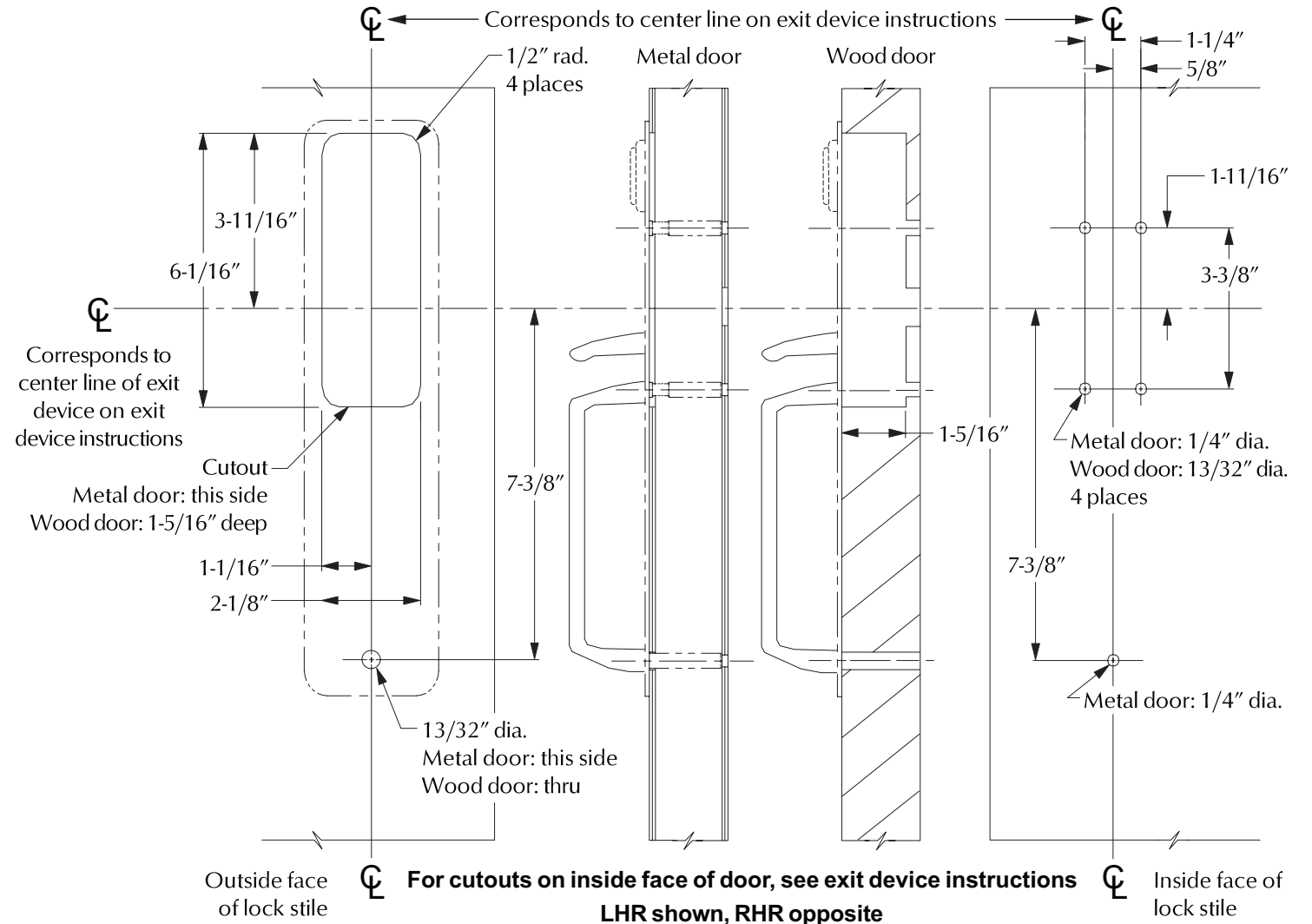
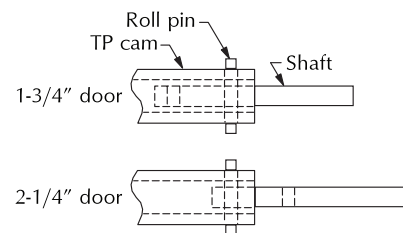

Customer Service

1-877-671-7011 www.allegion.com/us



© Allegion 2014
Printed in U.S.A.
921038-00 Rev. 01/14-b